

GROUND FLOOR

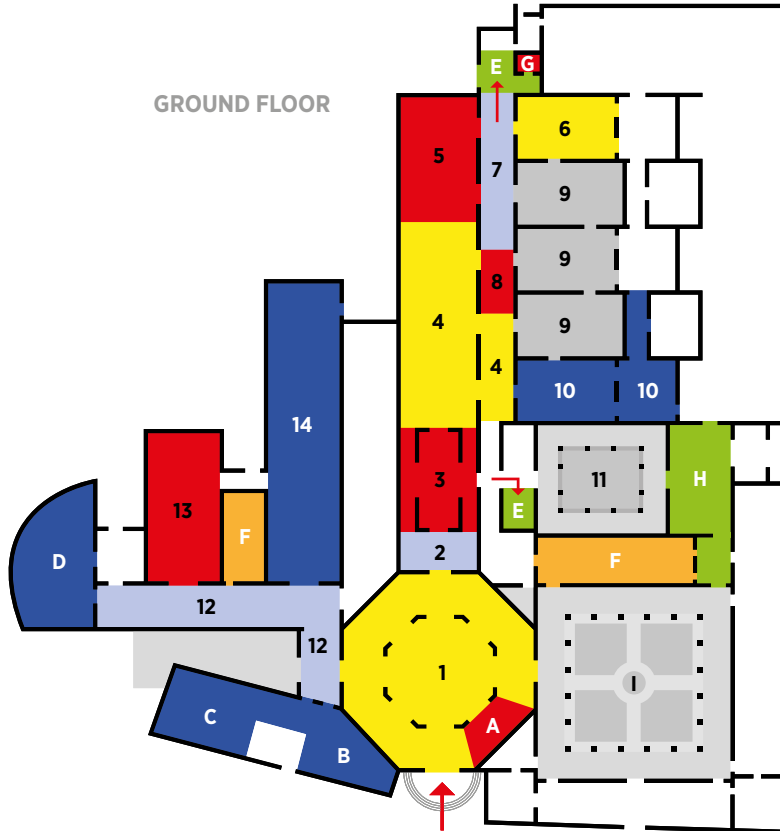

AMBASSADOR VICH COURTYARD (ca. 1525)

GROUND FLOOR

- A** Reception and tickets
- B** Shop / Creative Space
- C** Cafeteria and restaurant
- D** Auditorium
- E** Stairs
- F** Toilets
- G** Lifts
- H** Stairs
- I** Cloister of the Seminar of St Pius V

- 1** Lobby
- 2** Medieval architecture from Valencia
- 3** Roman art and sumptuary arts from Valencia
- 4** Valencian Gothic Art
- 5** 15th and 16th century Valencian Renaissance
- 6** Mannerist Renaissance
- 7** 15th and 16th century Flemish Painting
- 8** Italian and Castilian Renaissance
- 9** 17th century Valencian Baroque
- 10** Temporary exhibition room
- 11** Ambassador Vich Courtyard
- 12** Mariano Benlliure sculpture gallery
- 13** Temporary exhibition room
- 14** Temporary exhibition room

FIRST FLOOR

- 15** Spanish Baroque
- 16** Italian Baroque
- 17** 17th century Flemish Art
- 18** Academic and Romantic Art
- 19** Temporary exhibition room
- 20** Joaquín Sorolla
- 21** The Influence of Sorolla: Disciples
- 22** Sorollismo. The Followers of Sorolla
- 23** Post-Sorollismo and Renewal
- 24** Workshop studios

SECOND FLOOR

- 25** Sorolla's Forerunners
- 26** Sorolla's Masters
- 27** Sorolla's Environs: His Friends, His Colleagues and His Time

FIRST FLOOR

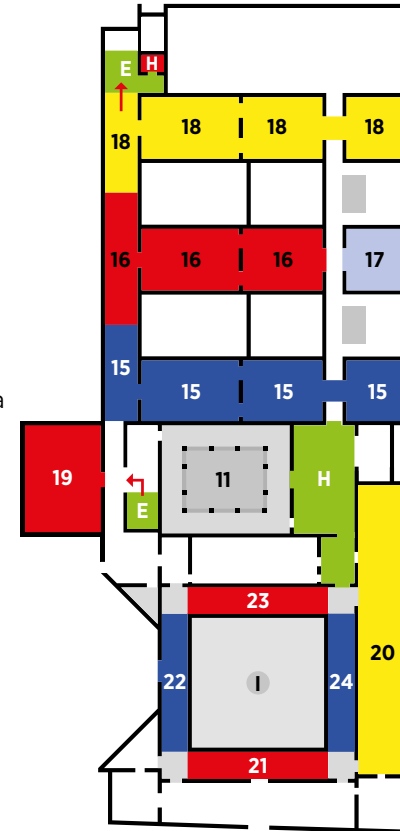

SECOND FLOOR

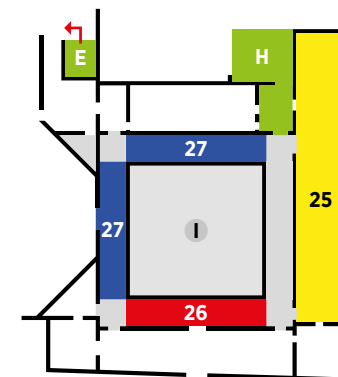

ROOM 4

Gonçal Peris: *Altarpiece of St Martin with St Ursula and St Anthony the Great*

ROOM 5

Joan de Joanes: *The Virgin of the venerable Agnes*

ROOM 8

Bernardino di Benedetto di Biagio, "Il Pinturicchio": *Virgin of the Fevers*

ROOM 9

Jerónimo Jacinto de Espinosa: *Father Jerónimo Mos*

ROOM 9

Francisco Ribalta: *St Francis of Assisi Embracing Christ Crucified*

ROOM 15

José de Ribera: *St Sebastian Nursed by St Irene and Her Maid*

ROOM 15

Bartolomé Esteban Murillo: *St Francis of Assisi Preaching*

ROOM 15

Alonso Cano: *St Vicente Ferrer Preaching*

ROOM 15

Diego Velázquez: *Self-portrait*

ROOM 17

Matthias Stom: *St Sebastian Nursed by St Irene and Her Maid*

ROOM 17

Albert Awercx: *Poseidon and Amphitrite*

ROOM 18

Vicente López: *Portrait of general Ramón Narváez*

ROOM 18

Francisco de Goya: *Portrait of Joaquina Candado*

ROOM 20

Joaquín Sorolla: *Sketch for the poster for El Pueblo newspaper*

ROOM 22

Mariano Benlliure: *Chula*

OPENING HOURS

Tuesday – Sunday: 10.00 am – 8.00 pm

GETTING HERE

Lines 6, 11, 16, 26, 28, 79, 94, 95



Stations: Alameda, Pont de Fusta



Stations: 131 (Alboraya-Flora), 83 (General Elío-Pla del Real), 5 (Plaza Poeta Llorente)

VISITOR INFORMATION

- All large bags, packages, backpacks, umbrellas and other large objects that may pose a risk for the artworks must be left in the cloakroom.
- Photography is allowed without flash and without tripods or other stabilising elements. Photography or recording images is not allowed in temporary exhibitions.
- For conservation reasons, the exhibition rooms are kept at a constant temperature of 21°C. On hot days we recommend visitors to bring warm clothing.
- Food and drink are not allowed to be brought into the museum.
- Smoking is forbidden in the museum, including its open-air spaces.
- Please do not touch any of the works on exhibit for conservation reasons.

Museu de Belles Arts de València

C/. Sant Pío V, 9 • 46010 Valencia

Tel. (+34) 96 387 03 00 • Fax (+34) 96 387 03 01
museobellasartesvalencia@gva.es



museobellasartesvalencia.gva.es



GVAMuseodeBellasArtesValencia



GVAmubav



GVAMuseoBellasArtes



gvamubav